

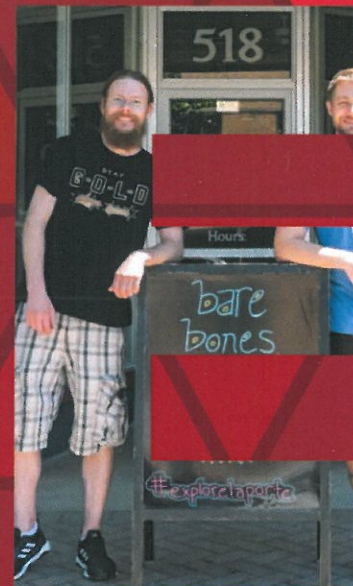

La Porte URBAN ENTERPRISE Association

Working for Our Economic Future

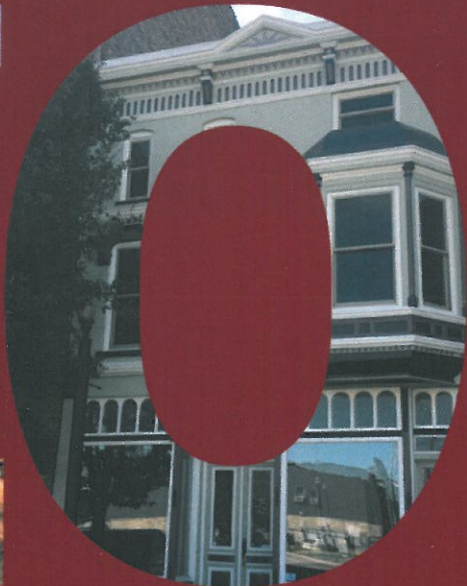
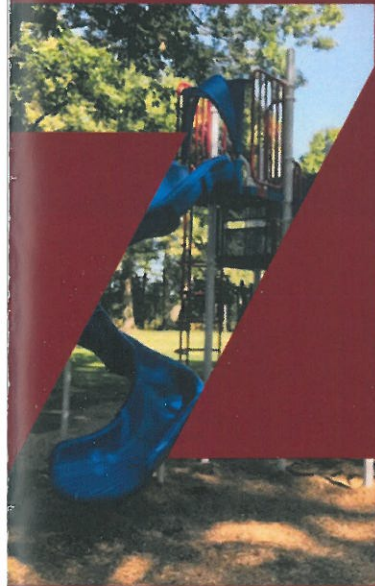

IN THE ZONE

**La Porte Urban Enterprise Zone
Programs & Incentives**

IN THE ZONE

The La Porte Urban Enterprise Association (LPUEA) is a 501(c)3 not for profit organization which serves as the governing body of the La Porte Urban Enterprise Zone. The Association acts as a liaison among Zone residents, businesses and the City of La Porte for any development activity and programs that affect the Zone and its residents.

The Mission of the La Porte Urban Enterprise Association is:

To be a comprehensive economic and community development organization that fosters new investments, partnerships, job creation and redevelopment of the Enterprise Zone.

The Enterprise Zone was established in 2002 for the purpose of creating jobs and new business opportunities, while raising the quality of life within the community. The Zone covers close to a four square mile designated portion of land within the City of La Porte. Within its borders are more than 450 businesses and a population of over 6,200 residents.

The Zone is a hallmark for urban revitalization and a cornerstone for economic growth and development.

Operating a business IN THE ZONE, Working for a company IN THE ZONE and living IN THE ZONE offer a number of advantages and incentives. Zone programs help to revitalize the area and promote a better quality of life.



Zone Programs and Incentives

The La Porte Urban Enterprise Zone offers three categories of incentives:

1. To Zone businesses to encourage investment and reinvestment in their business
2. To individual residents residing and working in the Zone

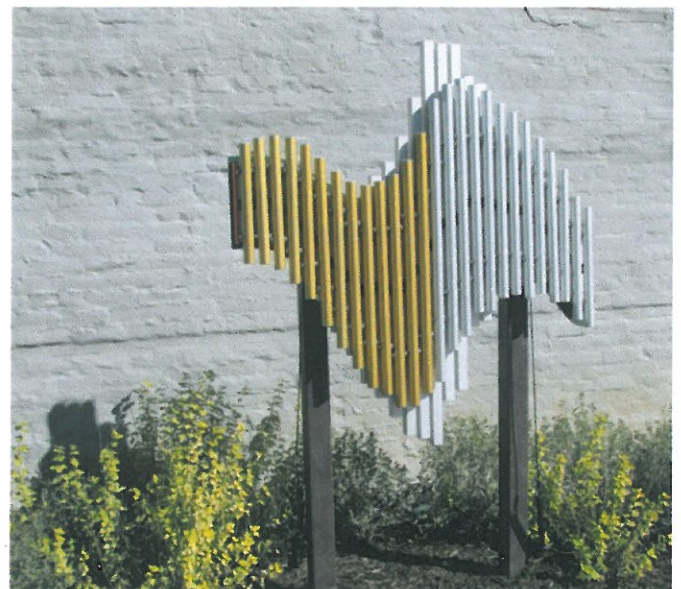



Enterprise Zone Investment Deduction

Zone businesses can receive a tax deduction for the increased value of a business property due to a real and personal property qualified investment by the business.

The added valuation may be deducted for up to 10 years. Examples of “qualified investments” include: purchase or construction of a new or existing building, purchase of new manufacturing or production equipment, costs associated with the repair or modernization of an existing building and onsite infrastructure improvements.



Employment Expense Credit

Employers operating a business in the Zone may apply a 10% credit to its State adjusted gross income tax, insurance premium tax and financial institution tax liabilities for the increase in wages paid to qualified Zone resident employees, up to \$1,500 per employee.

Employment Tax Deduction

Qualified employees who live and work in the Zone are entitled to a State tax deduction equal to one-half of their adjusted State gross income, up to \$7,500.

A qualified employee is an individual whose principal place of residence is in the Zone, who works 50% of their time for a Zone business and has at least 90% of their service directly related to the employer’s Zone business.

Grant Programs Available

There are several grant opportunities for Zone businesses including: Business Facade Grant, Business Grants and Residential Grants. Visit the UEA page for updated grant applications.

For Participation & Eligibility Requirements Contact:

*La Porte Economic
Advancement Partnership (LEAP)
809 Washington Street
La Porte, IN 46350
(219) 324-8584*

*www.laportepartnership.com
(Click “COMMUNITY” tab and select “LPUEA”)*

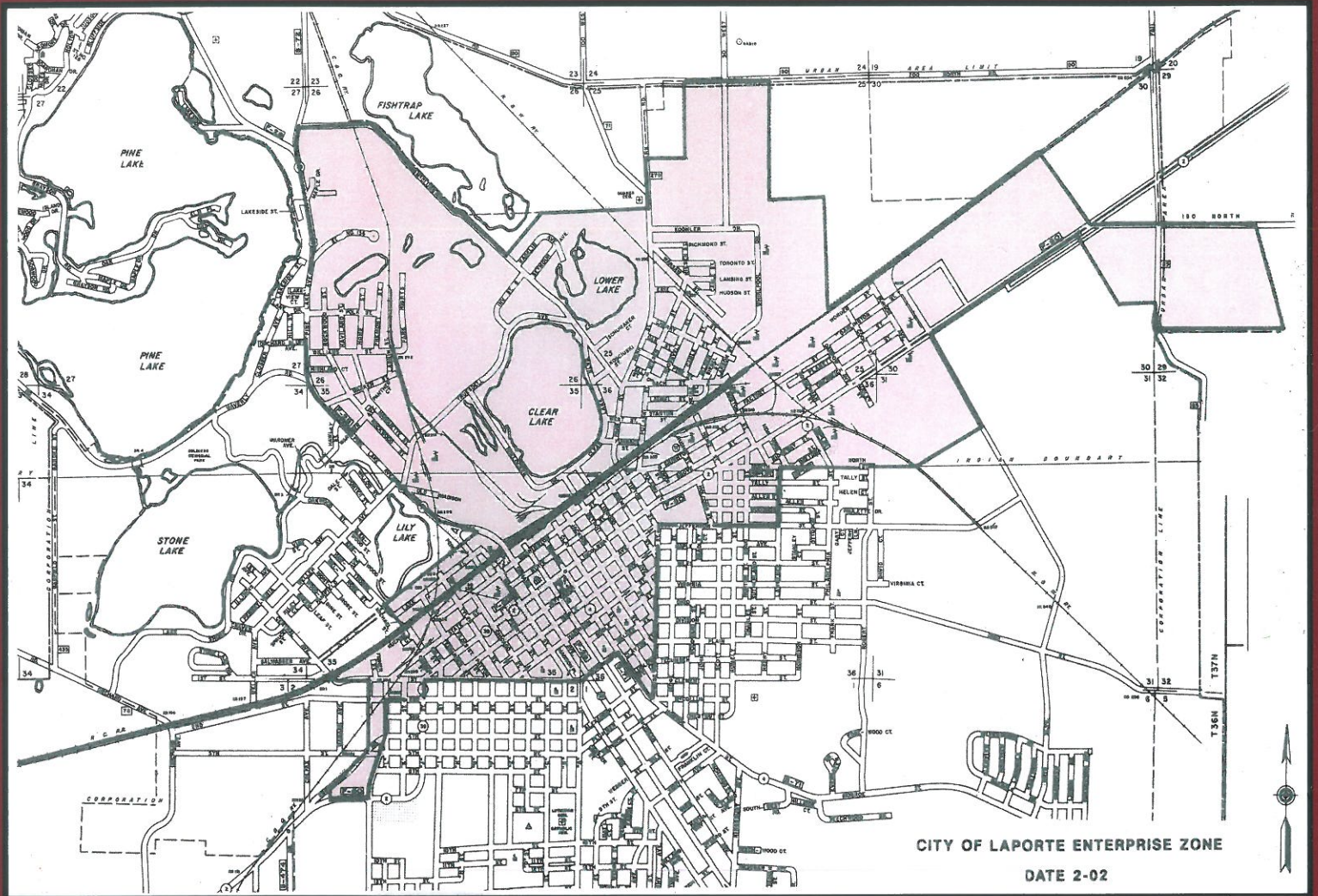

To see if your property is *In The Zone*, Contact the City of La Porte at 219-362-8260.



La Porte URBAN ENTERPRISE Association

Working for Our Economic Future

www.laportepartnership.com (Click "COMMUNITY" tab and select "LPUEA")